

DRAWING TITLE :-
LANDUSE PLAN



SHEET NO.- 19
DECLARATION OF ARCHITECT.

CERTIFIED THAT THE PLAN ITSELF WITH FULL RESPONSIBILITY THAT THE BUILDING PLAN HAS DRAWN UP AS PER PROVISION OF K.M.C. BUILDING RULES 2008, AS AMENDED FROM TIME TO TIME AND THE SITE CONDITION INCLUDING THE NOTING ROAD IS CONFORM WITH THE PLAN. IT IS A BUILDABLE SITE NOT A SWAMP OR FLOODED UP TANK. THERE IS NO EXISTING STRUCTURE TO BE OBLISHED BEFORE COMMENCEMENT OF WORK. IT IS FULLY OCCUPIED BY THE OWNER. THERE IS NO TENANT.

DHRUBOJYOTI SAHA
REG. NO. - 02/2005/35277
NAME OF ARCHITECT.

CERTIFICATE OF STRUCTURAL ENGINEER

THE STRUCTURAL DESIGN OF BOTH FOUNDATION AND SUPERSTRUCTURE OF THE BUILDING HAVE BEEN MADE BY ME CONSIDERING ALL POSSIBLE LOADS INCLUDING THE SEISMIC LOAD AS PER N.B.C. OF INDIA AND BASIS OF SOIL INVESTIGATION REPORT BY DR. BIKAS MAITI, PIONEER TOWER AB-10/AA-1, PREMISES NO.-20/085 NEW TOWN, KOLKATA-700150. CERTIFY THAT IT IS SAFE AND STABLE IN ALL RESPECT.

DHIMAN BHATTACHARJEE E.S.E.
NO. - 212, CLASS - I
NAME OF STRUCTURAL ENGINEER

DECLARATION OF APPLICANT / OWNER.
I DO HEREBY DECLARE WITH FULL RESPONSIBILITY THAT I SHALL DISCHARGE L.B.A & E.S.E DURING CONSTRUCTION. I SHALL FOLLOW THE INSTRUCTION OF L.B.A & E.S.E DURING CONSTRUCTION OF THE BUILDING AS PER PLAN. K.M.C. AUTHORITY WILL NOT BE RESPONSIBLE FOR STRUCTURAL STABILITY OF THE BUILDING & ADJOINING STRUCTURE IF ANY SUBMITTED DOCUMENT ARE FALSE. THE K.M.C. AUTHORITY WILL REMOVE THE SANCTION PLAN. THE CONSTRUCTION OF BUILDING SHALL BE UNDER THE GUIDANCE OF J.B.E.S.E BEFORE STARTING OF BUILDING FOUNDATION.

DTL. ESTATE PVT. LTD. & 29 OTHERS
NAME OF OWNER

CERTIFICATE OF GEO TECHNICAL ENGINEER

THE SOIL INVESTIGATION REPORT OF THE SAID PREMISES HAVE BEEN MADE BY (DR. BIKAS MAITI), PIONEER TOWER AB-10/AA-1, PREMISES NO.-20/085 NEW TOWN, KOLKATA-700150. ME ON THE BASIS OF SOIL TEST AS PER GUIDELINE PROVIDED BY B.I.S. CODE.

DR. BIKAS MAITI
G.T.E.
NO. - 52, CLASS - I
NAME OF GEO TECHNICAL ENGINEER

CERTIFICATE OF STRUCTURAL REVIEWER

I REVIEW THE STRUCTURAL DESIGN OF BOTH FOUNDATION AND SUPERSTRUCTURE OF THE BUILDING HAVE BEEN MADE BY ME CONSIDERING ALL POSSIBLE LOADS INCLUDING THE SEISMIC LOAD AS PER N.B.C. OF INDIA AND BASIS OF SOIL INVESTIGATION REPORT BY DR. BIKAS MAITI, PIONEER TOWER AB-10/AA-1, PREMISES NO.-20/085 NEW TOWN, KOLKATA-700150. CERTIFY THAT IT IS SAFE AND STABLE IN ALL RESPECT.

UTPAL SANTRA
E.S.R.
NO. - 58/10, CLASS - I
NAME OF STRUCTURAL REVIEWER

MBC MEETING NO.- 641 DATED:- 29.08.2024
MBC ITEM NO. - 106/24-25
B.P.NO. - 2024130131
Dated:-25.09.2024
Validity:-24.09.2029

DIGITAL SIGNATURE OF E.E

DIGITAL SIGNATURE OF A.E

NORTH :- SCALE :-

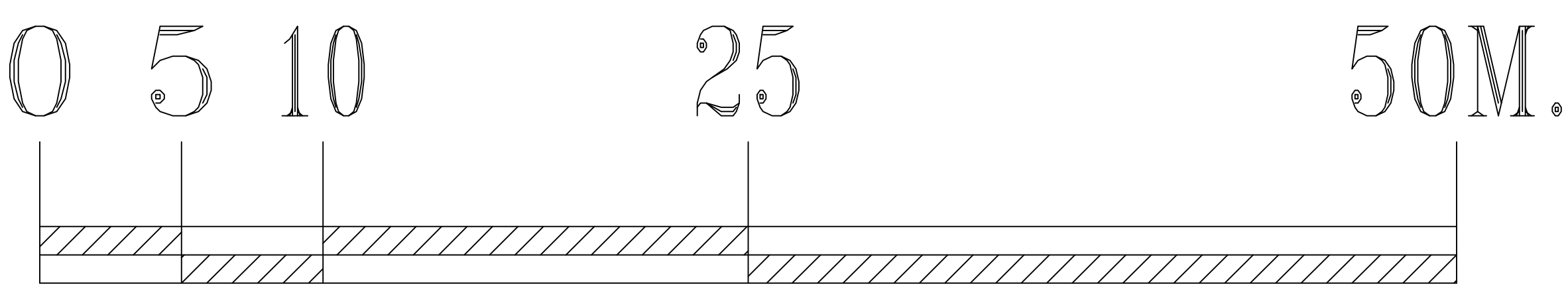
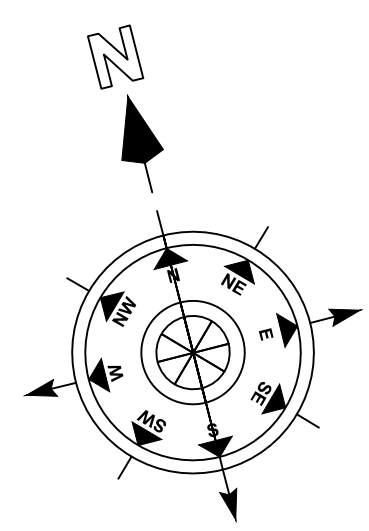

LANDUSE STATEMENT_ JAMES LONG			
DETAILS	VALUE	UNIT	%
LAND AREA	16065.75	sqm	100.00
GROUND COVERAGE	5575.26	sqm	34.70
SERVICE AREA	544.56	sqm	3.39
PAVED AREA	3637.77	sqm	22.64
POND/ WATER BODY AREA	3865.08	sqm	24.06
EXCLUSIVE TREE PLANTATION AREA	2443.08	sqm	15.21
TOTAL	16065.75	sqm	100.00
EXCLUSIVE TREE PLANTATION AREA AS PER MEMO NO. 2495/EN/T-II-1/011/2018. DATED 17.12.2019, FOR WATER BODY AREA, OF MORE THAN 10% OF LAND AREA			
LAND AREA	16065.75	sqm	100.00
AREA OF WATER BODY	3865.08	sqm	24.06
NET LAND AREA	12200.67	sqm	100.00
EXCLUSIVE TREE PLANTATION AREA	2443.08	sqm	20.02

LEGENDS :-

POND AREA

GROUND COVERAGE AREA

PAVED AREA

SERVICE AREA

TREE PLANTATION AREA

OPEN PARKING AREA

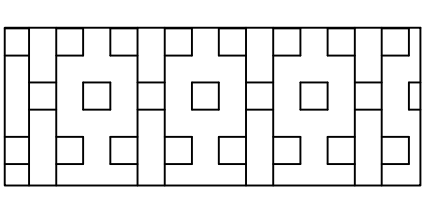
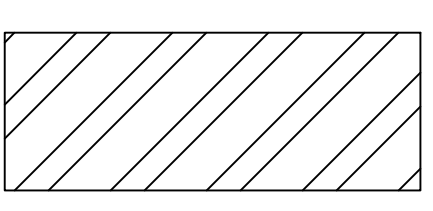
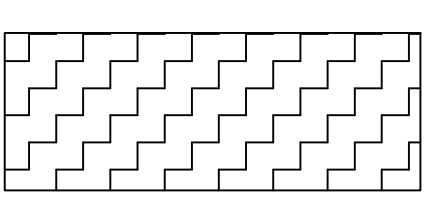
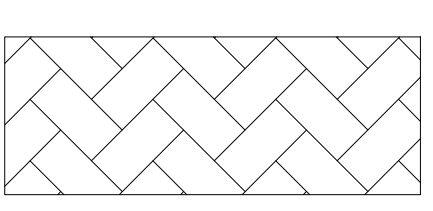
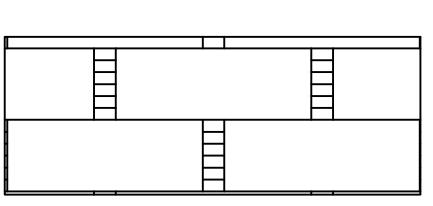
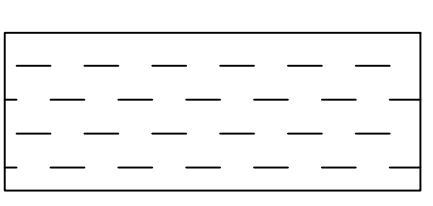

PROJECT :-

SUPERSEDING PLAN OF PROPOSED B+G+XXI STORIED RESIDENTIAL BUILDING BLOCK-A (HAVING HT. 72.6 M. COMPRISING OF TOWER-1,2&3) AND G+XVII STORIED DATED:- 21/02/2015 & SUBSEQUENTLY REVALIDATED UP TO 20/02/2025 RESIDENTIAL BUILDING BLOCK- B(HAVING HT. 60.0 M) AT PREMISES NO.- 43, VIPOBA BHAVE ROAD, KOLKATA -700038, WARD-119, BOROUG-H-XIII, P.S.- NEW ALIPORE, UNDER K.M.C., VIDE B.S. PLAN NO.: -2014130488, DATED 21/02/2015 & SUBSEQUENTLY REVALIDATED UP TO:- 20/02/2025